

How to disable the battery saver?

iPhone

iOS 17

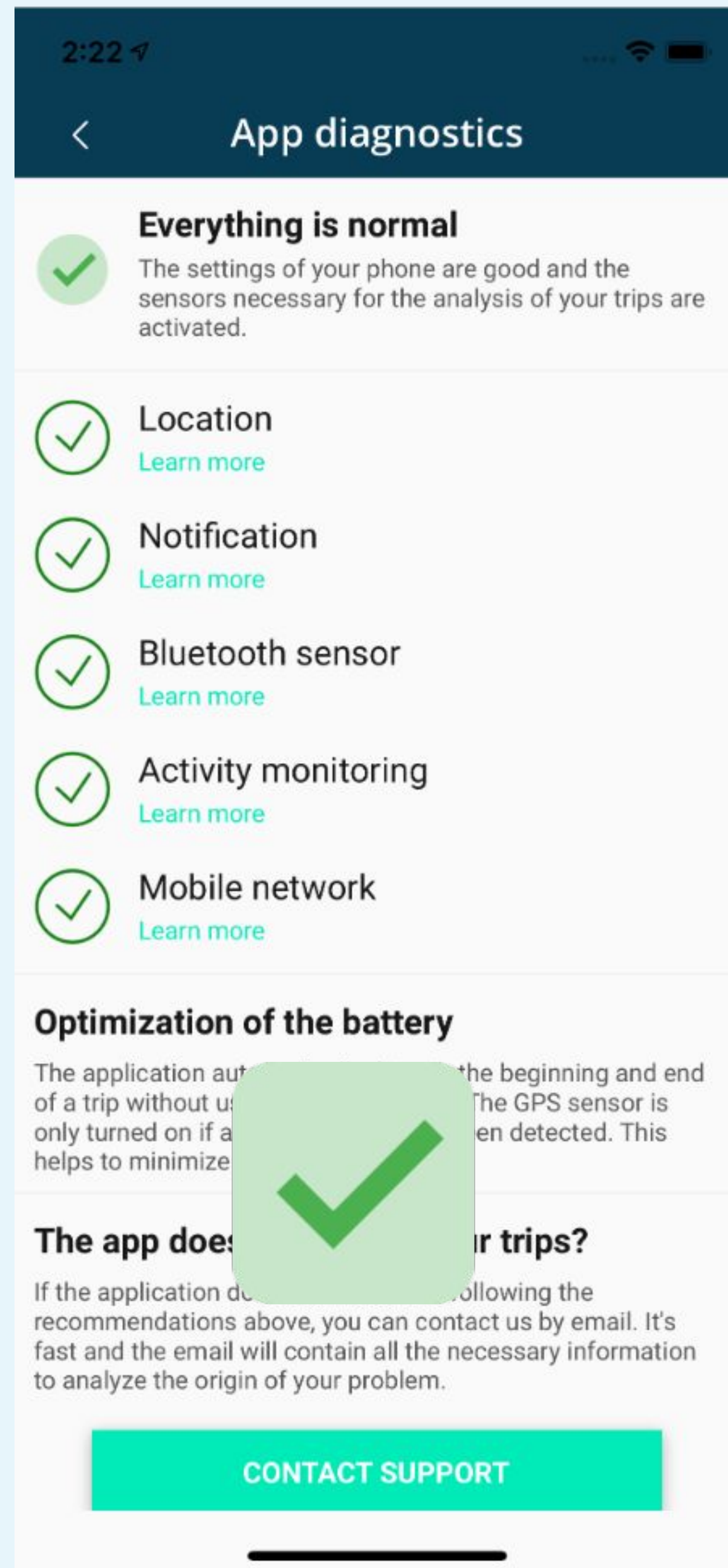
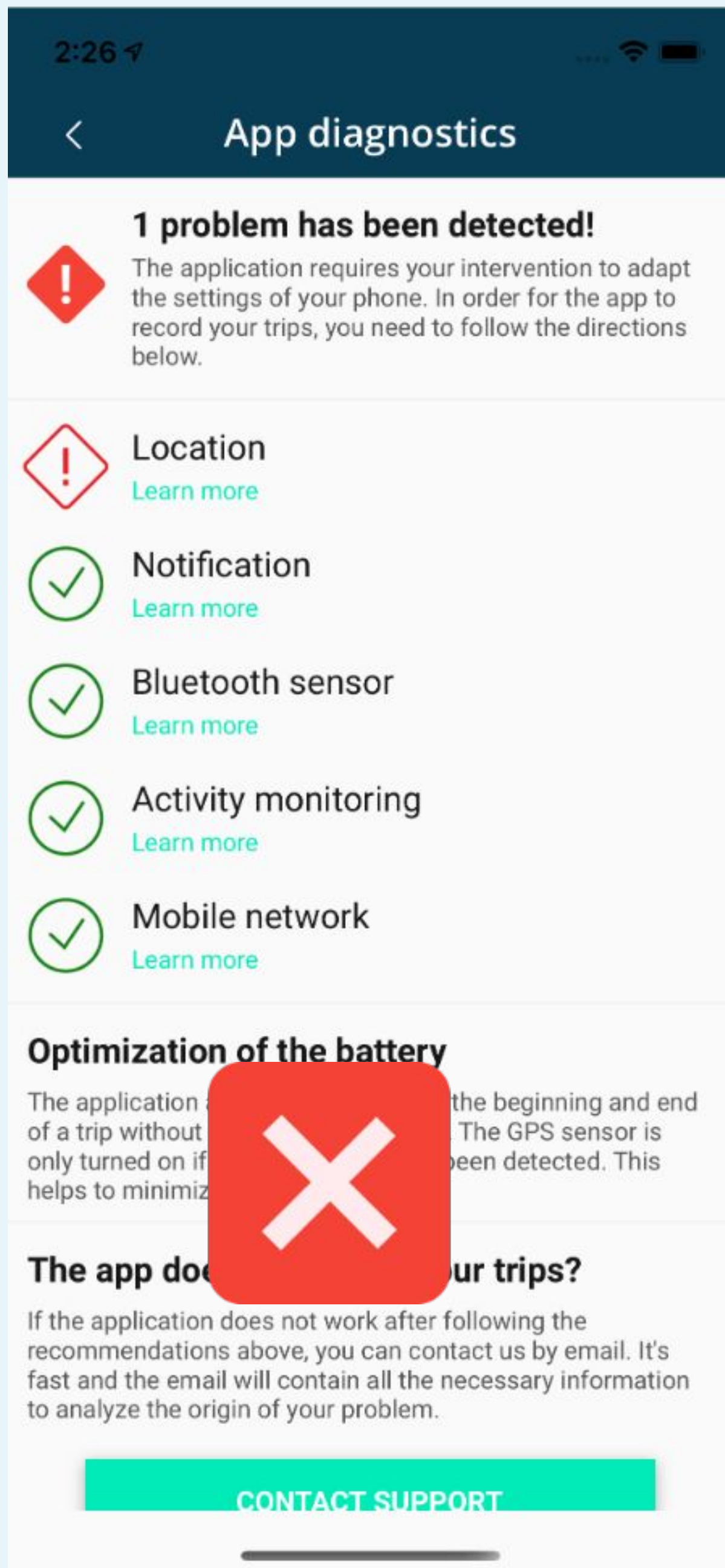

LOCATION

If you do not allow access to the location or enable the precise location, an alert will be displayed on the app's **Diagnostics** screen

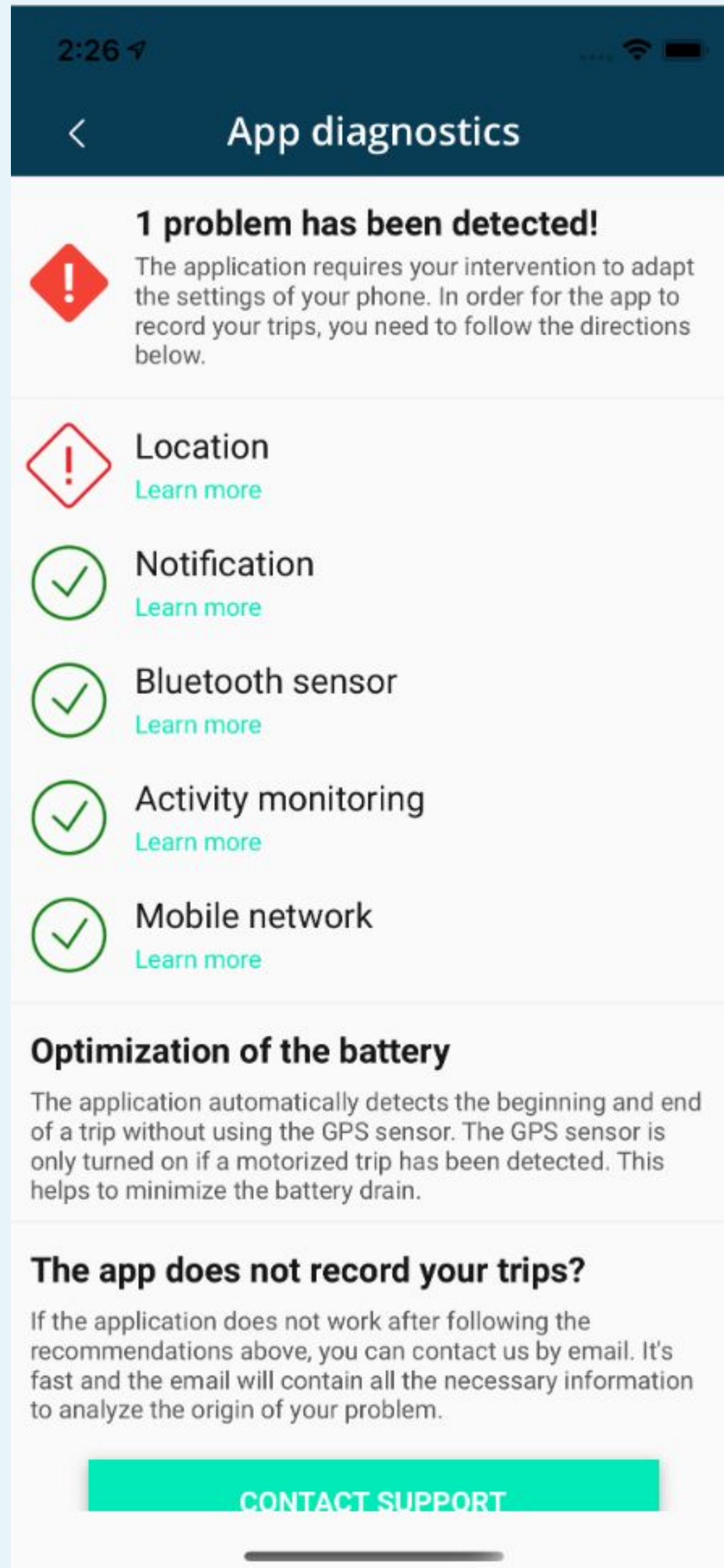

LOCATION

← In this case, select **Learn more** under Location

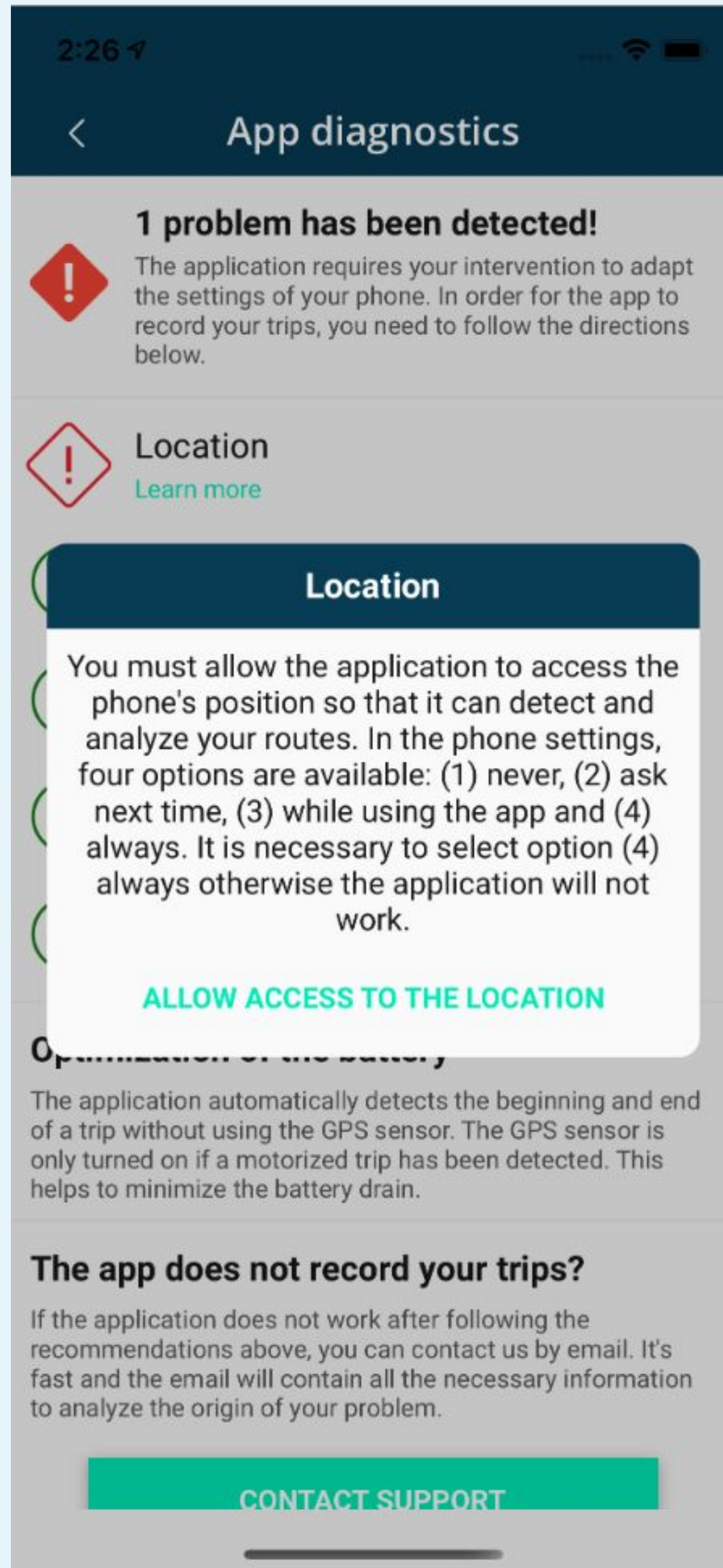

LOCATION



If the issue comes from a location access, follow the instructions and select **Allow the access**

LOCATION

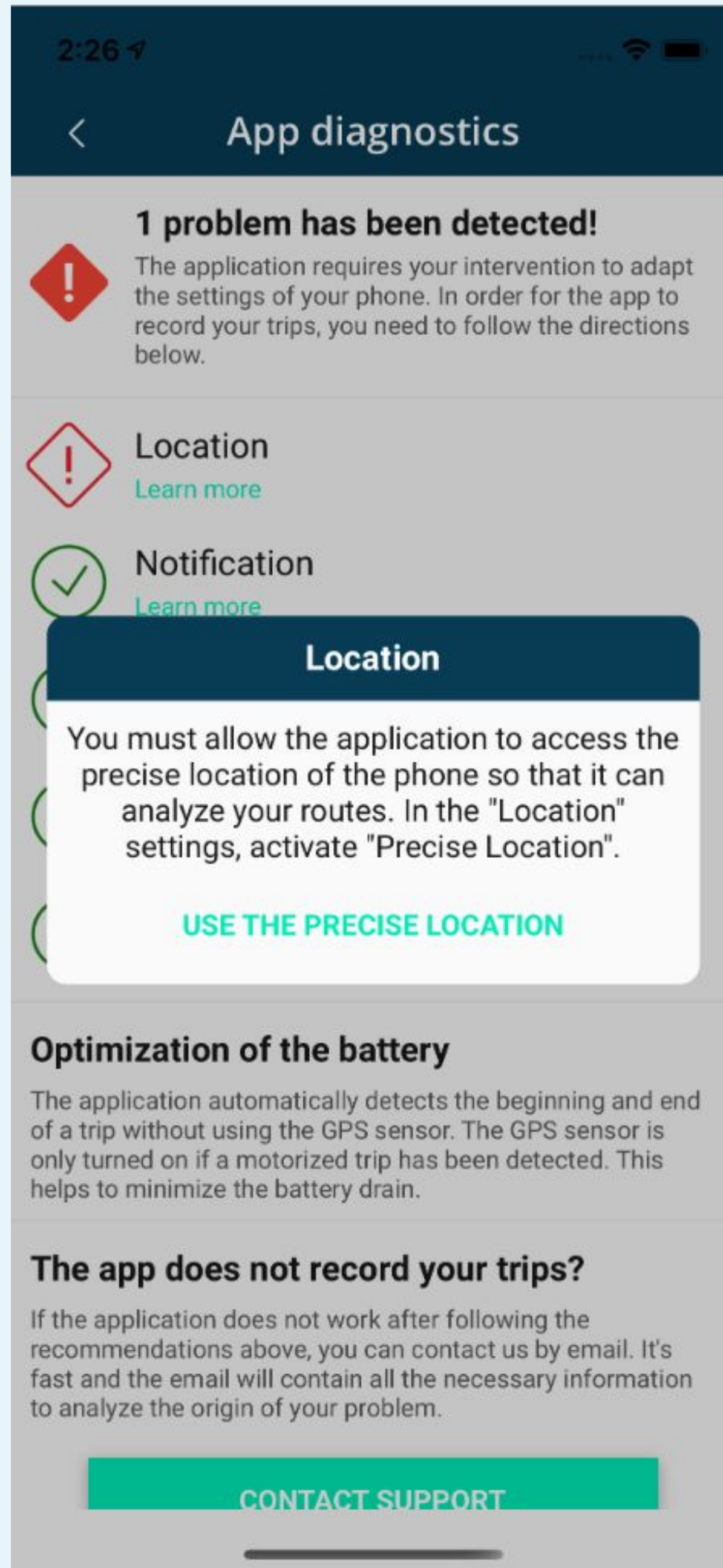

If the issue comes from the precise location, follow the instructions and select **Use the precise location**

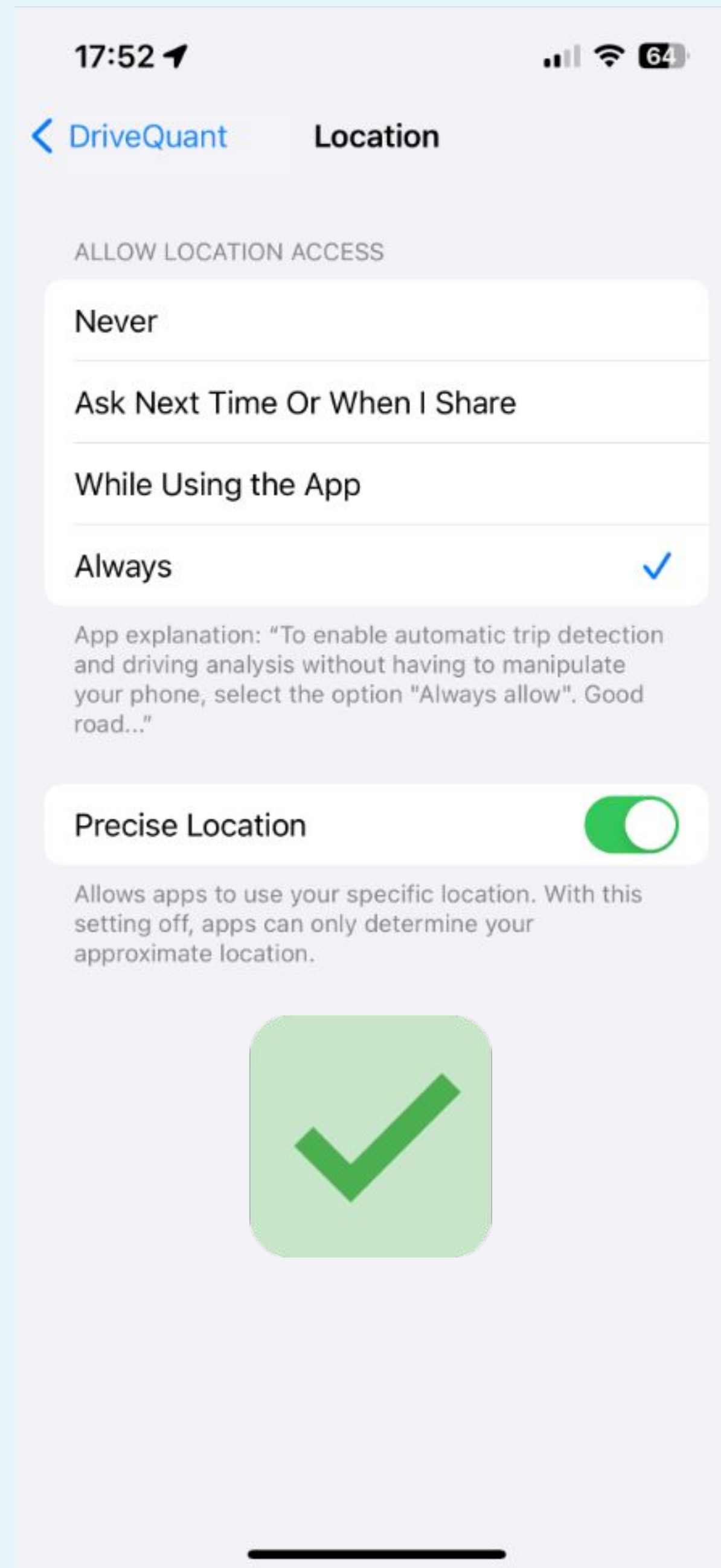
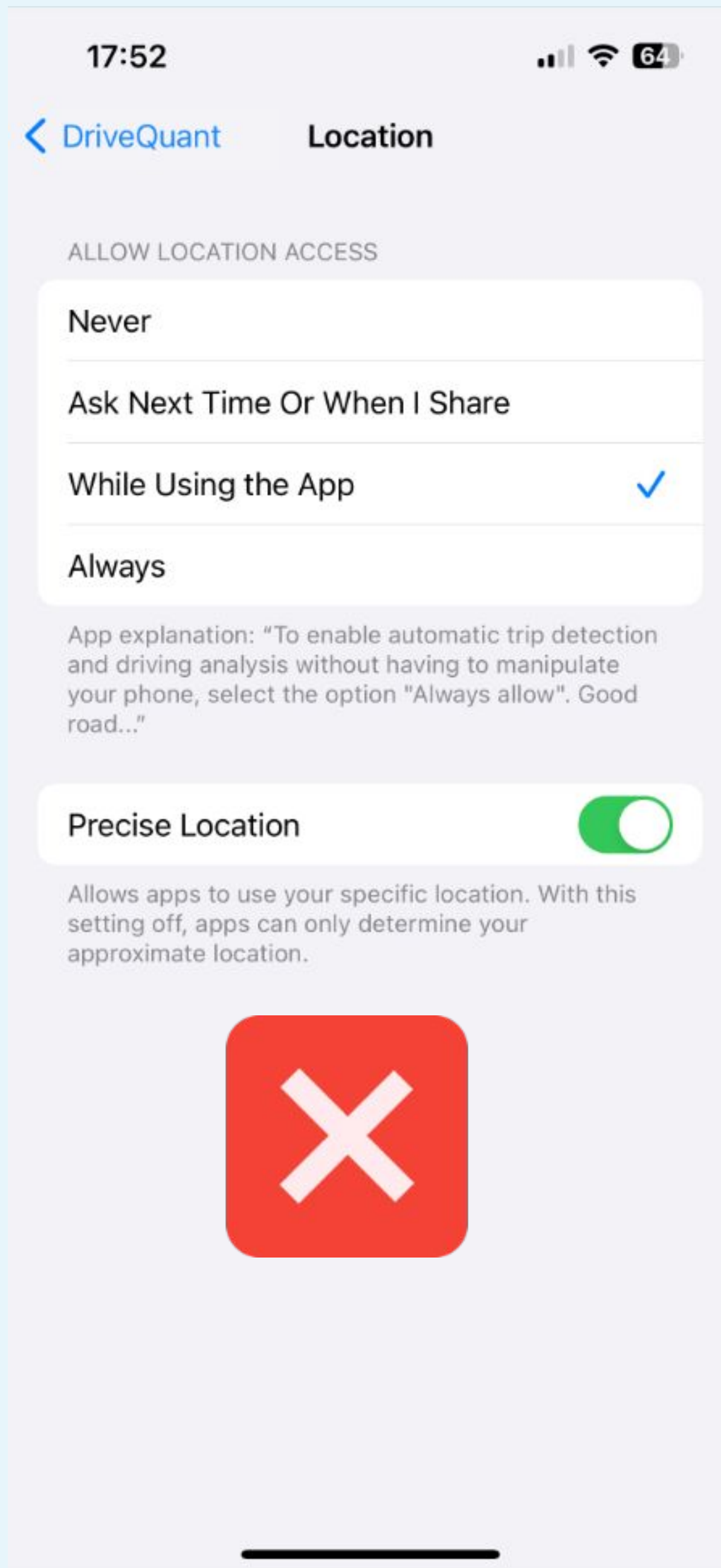

LOCATION

The location access must be **Always**

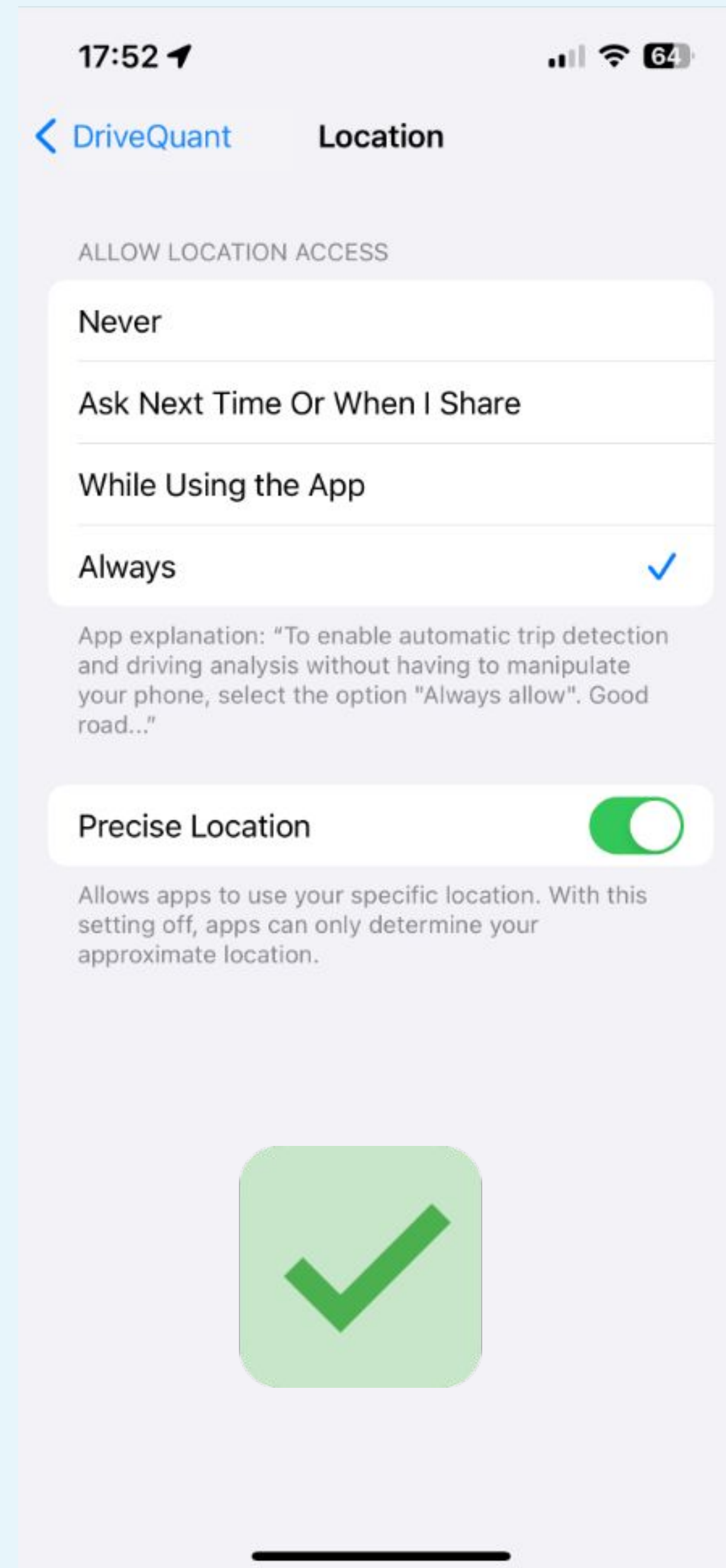
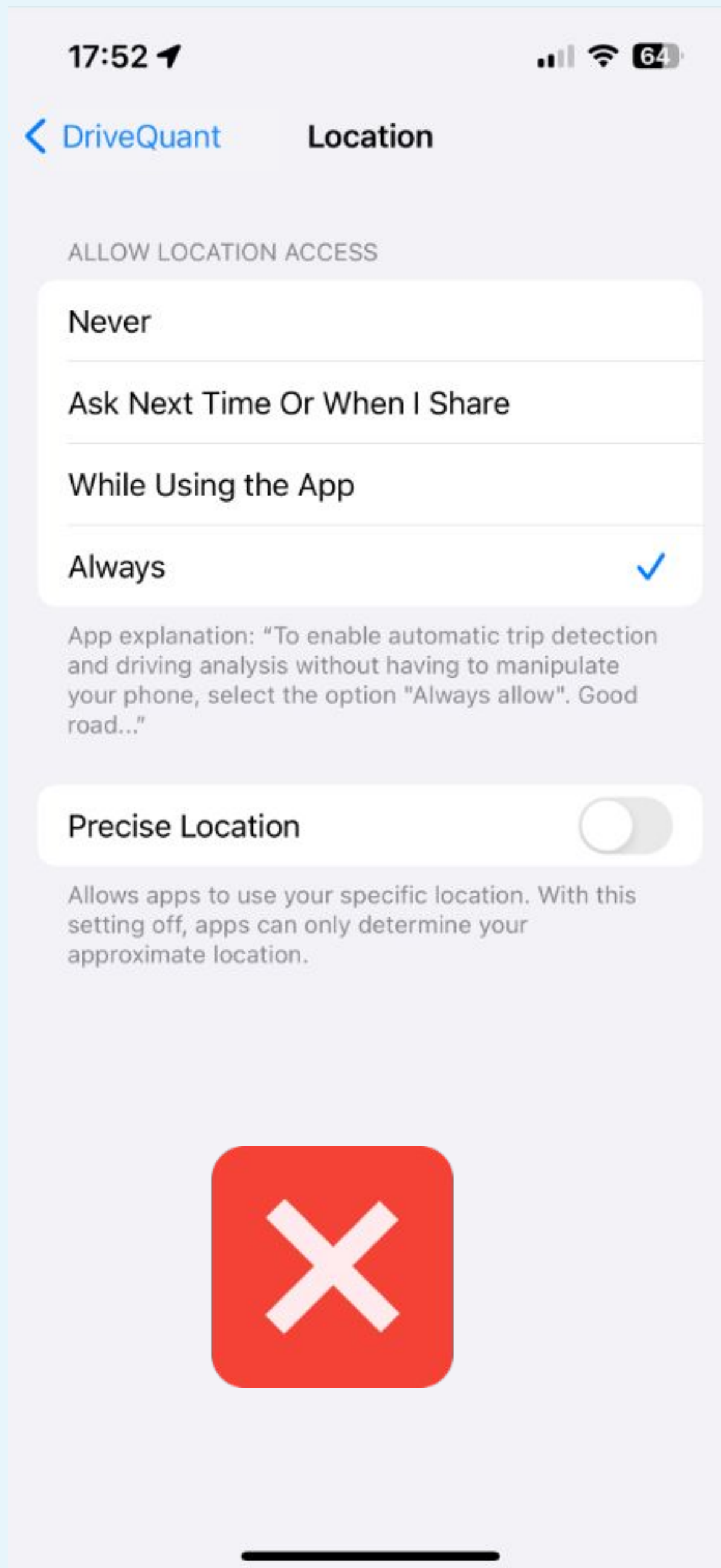

LOCATION

The precise location must be enabled

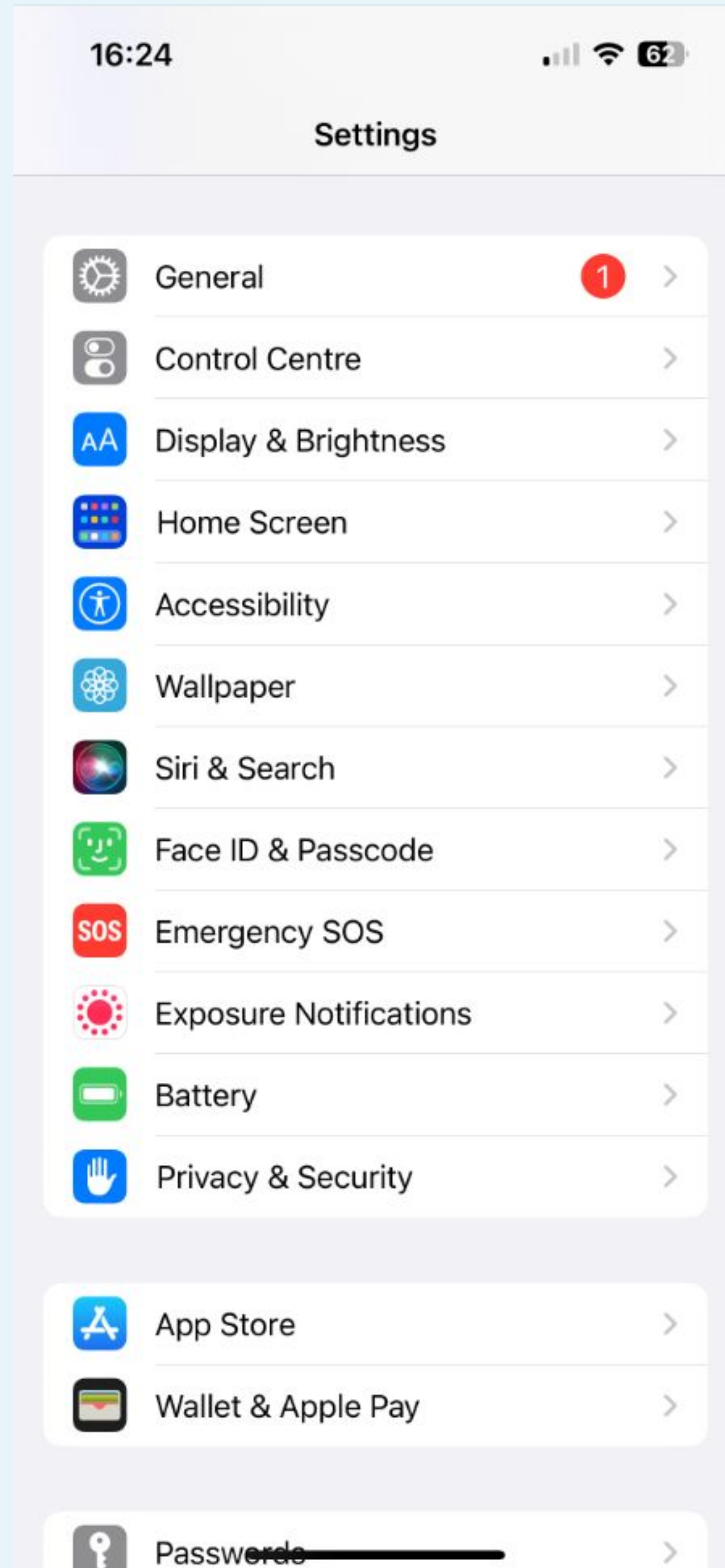

BATTERY

← Go in phone settings and select
Battery

BATTERY

Low Power Mode must be disabled

